

PC: Racor Instantáneo Recto Cónico

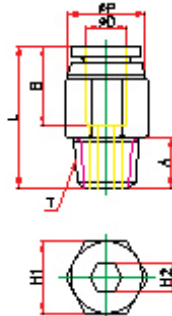

Male Straight



MODELO	D	P	T	L	A	B	H1	H2	Orificio	PESO
PC04-M5	4	10.0	M5*0.8	21.9	4.6	15.9	10	-	2.5	5.8
PC04-M6	4	10.0	M6*1.0	21.9	4.1	15.9	10	-	3.0	5.8
PC04-01	4	10.0	R 1/8	21.6	8.0	15.9	10	3	3.0	7.8
PC04-02	4	10.0	R 1/4	20.6	10.0	15.9	14	3	3.0	14.8
PC04-03	4	10.0	R 3/8	22.0	11.0	15.9	17	3	3.0	26.8
PC06-M5	6	12.0	M5*0.8	23.6	4.6	16.5	12	-	2.5	8.8
PC06-M6	6	12.0	M6*1.0	23.1	4.1	16.5	12	-	3.0	8.8
PC06-01	6	12.0	R 1/8	22.2	8.0	16.5	12	4	4.0	8.8
PC06-02	6	12.0	R 1/4	21.0	10.0	16.5	14	5	5.0	12.8
PC06-03	6	12.0	R 3/8	22.0	11.0	16.5	17	5	5.0	25.8
PC06-04	6	12.0	R 1/2	29.3	14.0	16.5	19	5	5.0	49.8
PC08-01	8	14.0	R 1/8	27.5	8.0	17.7	14	5	5.0	14.7
PC08-02	8	14.0	R 1/4	25.5	10.0	17.7	14	6	6.0	18.7
PC08-03	8	14.0	R 3/8	23.0	11.0	17.7	17	6	6.0	21.7
PC08-04	8	14.0	R 1/2	29.7	14.0	17.7	19	6	6.0	49.7
PC10-01	10	16.1	R 1/8	28.7	8.0	18.6	17	5	5.0	21.5
PC10-02	10	16.1	R 1/4	30.7	10.0	18.6	17	6	6.0	24.5
PC10-03	10	16.1	R 3/8	24.7	11.0	18.6	17	8	8.0	41.5
PC10-04	10	16.1	R 1/2	29.7	14.0	18.6	19	8	8.0	51.5
PC12-01	12	19.0	R 1/8	32.3	8.0	20.9	19	5	5.0	28.3
PC12-02	12	19.0	R 1/4	32.8	10.0	20.9	19	6	6.0	36.3
PC12-03	12	19.0	R 3/8	29.8	11.0	20.9	19	8	8.0	30.3
PC12-04	12	19.0	R 1/2	29.8	14.0	20.9	19	8	8.0	48.3
PC14-03	14	21.8	R 3/8	36.6	11.0	23.8	22	10	10.0	42.0
PC14-04	14	21.8	R 1/2	40.0	14.0	23.8	22	10	10.0	49.0
PC16-03	16	24.0	R 3/8	37.3	11.0	24.8	24	10	10.0	50.0
PC16-04	16	24.0	R 1/2	40.3	14.0	24.8	24	10	10.0	63.0

PC-G: Racor Instantáneo Recto Cilíndrico



Male Straight

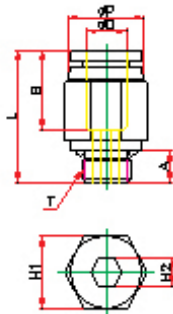

MODELO	D	P	T	L	A	B	H1	H2	Orificio	PESO
PC04-G01	4	10.3	G1/8	21.5	5.0	15.9	13	3	3.0	10.8
PC04-G02	4	10.3	G1/4	23.5	6.5	15.9	15	3	3.0	18.8
PC04-G03	4	10.3	G3/8	23.5	6.5	15.9	17	3	3.0	21.8
PC06-G01	6	12.3	G1/8	22.5	5.0	16.5	13	4	4.0	9.8
PC06-G02	6	12.3	G1/4	24.5	6.5	16.5	15	5	5.0	16.8
PC06-G03	6	12.3	G3/8	25.5	6.5	16.5	17	5	5.0	23.8
PC08-G01	8	14.3	G1/8	26.7	5.0	17.7	15	5	5.0	16.7
PC08-G02	8	14.3	G1/4	26.7	6.5	17.7	15	6	6.0	14.7
PC08-G03	8	14.3	G3/8	25.0	6.5	17.7	17	6	6.0	22.7
PC08-G04	8	14.3	G1/2	26.0	8.0	17.7	21	6	6.0	39.7
PC10-G01	10	16.5	G1/8	29.5	5.0	18.6	17	5	5.0	21.5
PC10-G02	10	16.5	G1/4	30.0	6.5	18.6	17	6	6.0	22.5
PC10-G03	10	16.5	G3/8	27.0	6.5	18.6	17	8	8.0	21.5
PC10-G04	10	16.5	G1/2	28.3	8.0	18.6	21	8	8.0	36.5
PC12-G02	12	19.0	G1/4	32.2	6.5	20.9	19	6	6.0	26.3
PC12-G03	12	19.0	G3/8	31.6	6.5	20.9	19	8	8.0	22.3
PC12-G04	12	19.0	G1/2	31.6	8.0	20.9	21	8	8.0	36.5
PC14-G03	14	21.8	G3/8	33.5	6.5	23.8	22	10	10.0	48.0
PC14-G04	14	21.8	G1/2	32.8	8.0	23.8	24	10	10.0	57.0
PC16-G03	16	24.0	G3/8	36.3	6.5	24.8	24	10	10.0	53.0
PC16-G04	16	24.0	G1/2	36.3	8.0	24.8	24	10	10.0	59.0

PCF: Racor Instantáneo Recto Hembra Cónico



Female Straight

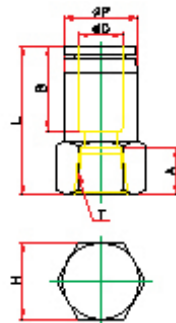

MODELO	D	P	T	L	A	B	H1	Orificio	PESO
PCF04-M5	4	10.0	M5*0.8p	25.6	7.0	15.9	12	3.5	8.8
PCF04-01	4	10.0	R1/8	26.7	8.0	15.9	14	3.5	15.8
PCF04-02	4	10.0	R1/4	28.7	10.0	15.9	17	3.5	19.8
PCF04-03	4	10.0	R3/8	29.7	11.0	15.9	22	3.5	33.8
PCF06-M5	6	12.0	M5*0.8p	25.8	7.0	16.5	12	4.2	10.8
PCF06-01	6	12.0	R1/8	27.3	8.0	16.5	14	5.0	17.8
PCF06-02	6	12.0	R1/4	29.3	10.0	16.5	17	5.0	23.8
PCF06-03	6	12.0	R3/8	30.2	11.0	16.5	22	5.0	35.8
PCF06-04	6	12.0	R1/2	32.2	14.0	16.5	24	5.0	39.8
PCF08-01	8	14.0	R1/8	28.5	8.0	17.7	14	6.0	18.7
PCF08-02	8	14.0	R1/4	30.5	10.0	17.7	17	6.0	25.7
PCF08-03	8	14.0	R3/8	31.5	11.0	17.7	22	6.0	38.7
PCF08-04	8	14.0	R1/2	33.5	14.0	17.7	24	6.0	45.7
PCF10-01	10	16.4	R1/8	31.4	8.0	18.6	17	8.5	31.5
PCF10-02	10	16.4	R1/4	31.5	10.0	18.6	17	8.5	26.5
PCF10-03	10	16.4	R3/8	32.4	11.0	18.6	22	8.5	39.5
PCF10-04	10	16.4	R1/2	34.4	14.0	18.6	24	8.5	40.5
PCF12-02	12	18.6	R1/4	34.7	10.0	20.9	22	10.0	53.3
PCF12-03	12	18.6	R3/8	34.7	11.0	20.9	22	10.0	43.3
PCF12-04	12	18.6	R1/2	36.7	14.0	20.9	24	10.0	49.3