

**PST-G: Racor Instantáneo "TE" Lateral Cilíndrico Or.**

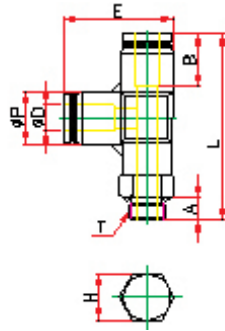

Male Run Tee



MODELO	D	P	T	L	E	A	B	H	Orificio	PESO
PST04-G01	4	10.5	G 1/8	42.8	25.1	5.0	16.8	14	3.0	14.6
PST04-G02	4	10.5	G 1/4	44.8	25.1	6.5	16.8	17	3.0	18.6
PST04-G03	4	10.5	G 3/8	44.3	25.1	6.5	16.8	20	3.0	23.6
PST06-G01	6	12.5	G 1/8	46.9	28.1	5.0	17.6	14	4.0	16.4
PST06-G02	6	12.5	G 1/4	48.9	28.1	6.5	17.6	17	4.0	22.4
PST06-G03	6	12.5	G 3/8	49.9	28.1	6.5	17.6	20	4.0	27.4
PST08-G01	8	14.5	G 1/8	50.1	30.9	5.0	18.7	14	6.0	19.4
PST08-G02	8	14.5	G 1/4	52.1	30.9	6.5	18.7	17	6.0	25.4
PST08-G03	8	14.5	G 3/8	53.1	30.9	6.5	18.7	20	6.0	30.4
PST08-G04	8	14.5	G 1/2	54.1	30.9	8.0	18.7	24	6.0	40.4
PST10-G01	10	17.5	G 1/8	53.8	34.6	5.0	19.6	17	6.0	28.4
PST10-G02	10	17.5	G 1/4	55.8	34.6	6.5	19.6	17	8.0	28.4
PST10-G03	10	17.5	G 3/8	56.8	34.6	6.5	19.6	20	8.0	34.4
PST10-G04	10	17.5	G 1/2	57.8	34.6	8.0	19.6	24	8.0	48.4
PST12-G02	12	20.5	G 1/4	62.2	40.3	6.5	21.9	19	8.0	43.2
PST12-G03	12	20.5	G 3/8	63.2	40.3	6.5	21.9	20	10.0	43.2
PST12-G04	12	20.5	G 1/2	64.2	40.3	8.0	21.9	24	10.0	55.2

**PWT: Racor Instantáneo "Y" Tubo - Rosca Cónica Or.**



Male Y

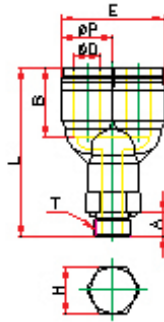

MODELO	D	P	T	L	E	A	B	H	Orificio	PESO
PWT04-M5	4	10.5	M5*0.8p	41.1	21.0	4.6	15.7	10	2.5	10.6
PWT04-M6	4	10.5	M6*1.0p	41.1	21.0	4.1	15.7	10	2.5	10.6
PWT04-01	4	10.5	R 1/8	43.6	21.0	8.0	15.7	10	3.0	11.6
PWT04-02	4	10.5	R 1/4	45.6	21.0	10.0	15.7	14	3.0	17.6
PWT04-03	4	10.5	R 3/8	46.6	21.0	11.0	15.7	17	3.0	25.6
PWT06-M5	6	12.5	M5*0.8p	42.0	25.0	4.6	17.0	12	2.5	15.4
PWT06-M6	6	12.5	M6*1.0p	40.6	25.0	4.1	17.0	12	3.0	15.4
PWT06-01	6	12.5	R 1/8	44.5	25.0	8.0	17.0	12	4.5	18.4
PWT06-02	6	12.5	R 1/4	47.5	25.0	10.0	17.0	14	4.5	19.4
PWT06-03	6	12.5	R 3/8	48.5	25.0	11.0	17.0	17	4.5	31.4
PWT06-04	6	12.5	R 1/2	51.5	25.0	14.0	17.0	21	4.5	45.4
PWT08-01	8	14.8	R 1/8	47.9	29.0	8.0	19.1	14	6.0	19.4
PWT08-02	8	14.8	R 1/4	50.9	29.0	10.0	19.1	14	6.0	25.4
PWT08-03	8	14.8	R 3/8	51.9	29.0	11.0	19.1	17	6.0	33.4
PWT08-04	8	14.8	R 1/2	54.9	29.0	14.0	19.1	21	6.5	51.4
PWT10-01	10	17.5	R 1/8	51.2	35.2	8.0	20.2	17	6.0	31.4
PWT10-02	10	17.5	R 1/4	54.2	35.2	10.0	20.2	17	7.0	36.4
PWT10-03	10	17.5	R 3/8	55.2	35.2	11.0	20.2	17	7.0	38.4
PWT10-04	10	17.5	R 1/2	58.2	35.2	14.0	20.2	21	7.0	58.4
PWT12-01	12	20.5	R 1/8	57.2	42.0	8.0	22.7	19	6.0	48.2
PWT12-02	12	20.5	R 1/4	59.2	42.0	10.0	22.7	19	7.0	51.2
PWT12-03	12	20.5	R 3/8	60.2	42.0	11.0	22.7	19	10.0	50.2
PWT12-04	12	20.5	R 1/2	63.2	42.0	14.0	22.7	21	10.0	62.2

**PWT-G : Racor Instantáneo "Y" Tubo Rosca Cilíndrica Or.**



Male Y

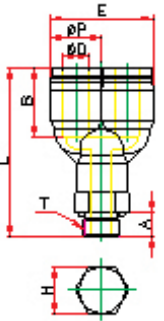

MODELO	D	P	T	L	E	A	B	H	Orificio	PESO
PWT04-G01	4	10.5	G 1/8	41.6	21.0	5.0	15.7	14	3.0	14.6
PWT04-G02	4	10.5	G 1/4	43.6	21.0	6.5	15.7	17	3.0	18.6
PWT04-G03	4	10.5	G 3/8	43.6	21.0	6.5	15.7	20	3.0	22.6
PWT06-G01	6	12.5	G 1/8	42.5	25.0	5.0	17.0	14	4.0	17.4
PWT06-G02	6	12.5	G 1/4	44.5	25.0	6.5	17.0	17	4.0	22.4
PWT06-G03	6	12.5	G 3/8	44.5	25.0	6.5	17.0	20	4.0	26.4
PWT06-G04	6	12.5	G 1/2	45.5	25.0	8.0	17.0	24	4.0	37.4
PWT08-G01	8	14.5	G 1/8	45.9	29.0	5.0	19.1	14	6.0	18.4
PWT08-G02	8	14.5	G 1/4	47.9	29.0	6.5	19.1	17	6.0	25.4
PWT08-G03	8	14.5	G 3/8	47.9	29.0	6.5	19.1	20	6.0	30.4
PWT08-G04	8	14.5	G 1/2	48.9	29.0	8.0	19.1	24	6.0	40.4
PWT10-G01	10	17.5	G 1/8	49.2	35.2	5.0	20.2	17	6.0	29.4
PWT10-G02	10	17.5	G 1/4	51.2	35.2	6.5	20.2	17	7.0	28.4
PWT10-G03	10	17.5	G 3/8	51.2	35.2	6.5	20.2	20	7.0	35.4
PWT10-G04	10	17.5	G 1/2	52.2	35.2	8.0	20.2	24	7.0	47.4
PWT12-G02	12	20.5	G 1/4	56.2	42.0	6.5	22.7	19	8.0	44.2
PWT12-G03	12	20.5	G 3/8	56.2	42.0	6.5	22.7	20	9.0	45.2
PWT12-G04	12	20.5	G 1/2	57.2	42.0	8.0	22.7	24	9.0	58.2

**PLM : Racor Instantáneo Pasamuros Codo**



Bulkhead Union Elbow

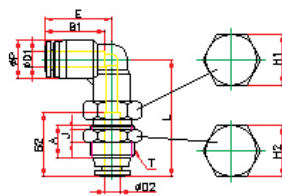

MODELO	D	P	T	L	E	A	B1	B2	J	H1-H2	Orificio	PESO	
PLM04	4	10.5	M12*1.0p	32.4	18.7	9.0	16.3	16.3	4.0	14	14	3.0	12.6
PLM06	6	12.5	M14*1.0p	38.2	20.4	11.0	17.5	17.0	4.0	17	17	4.5	14.5
PLM08	8	14.5	M16*1.0p	40.3	23.1	11.5	19.1	18.6	5.0	19	19	6.0	20.4
PLM10	10	17.5	M20*1.0p	42.3	23.7	12.0	19.7	20.3	5.0	24	24	7.0	29.7
PLM12	12	20.5	M22*1.0p	48.1	27.7	15.0	22.2	23.4	5.0	26	26	10.0	43.4