

**NSCP : Regulador de caudal con válvula manual descarga. Rosca con> Tubo**

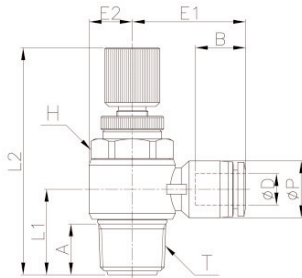

MODELO	T	P	H	C	N	E	B	A	K1	K2	L1	L2	M
NSCP 04-01	4	10.5	R 1/8	15.1	52.4	57.6	23.3	7.0	8.2	15.3	11	29.1	25
NSCP 04-02	4	10.5	R 1/4	18.4	51.3	57.1	25.3	9.0	11.0	15.3	15	40.2	25
NSCP 06-01	6	12.5	R 1/8	15.1	52.4	57.6	24.2	7.0	8.2	16.4	11	29.8	25
NSCP 06-02	6	12.5	R 1/4	18.4	51.3	57.1	26.2	9.0	11.0	16.4	15	41.1	25
NSCP 06-03	6	12.5	R 3/8	21.9	57.0	64.4	27.7	11.0	12.2	16.4	19	65.7	25
NSCP 06-04	6	12.5	R 1/2	26.5	63.4	70.6	30.8	14.0	16.5	16.4	24	103.0	15
NSCP 08-01	8	14.5	R 1/8	16.2	52.4	57.6	25.9	7.0	8.2	18.3	11	30.8	25
NSCP 08-02	8	14.5	R 1/4	19.2	51.3	57.1	27.9	9.0	11.0	18.3	15	42.1	25
NSCP 08-03	8	14.5	R 3/8	21.9	57.0	64.4	28.9	11.0	12.2	18.3	19	66.6	25
NSCP 08-04	8	14.5	R 1/2	26.5	63.4	70.6	31.8	14.0	16.5	18.3	24	103.8	15
NSCP 10-01	10	17.5	R 1/8	17.7	52.4	57.6	27.9	7.0	8.2	19.7	11	32.6	25
NSCP 10-02	10	17.5	R 1/4	20.7	51.3	57.1	29.9	9.0	11.0	19.7	15	43.9	25
NSCP 10-03	10	17.5	R 3/8	23.2	57.0	64.4	31.0	11.2	12.2	19.7	19	68.3	25
NSCP 10-04	10	17.5	R 1/2	26.5	63.4	70.6	33.4	14.0	16.5	19.7	24	105.5	15
NSCP 12-02	12	20.5	R 1/4	22.2	51.3	57.1	33.3	9.0	11.0	22.4	15	46.9	25
NSCP 12-03	12	20.5	R 3/8	24.0	57.0	64.4	33.7	11.5	12.2	21.9	19	71.1	25
NSCP 12-04	12	20.5	R 1/2	28.0	63.4	70.6	36.1	14.0	16.5	21.9	24	107.9	15

**NSCP : Regulador de caudal con válvula manual descarga. Rosca con> Tubo**

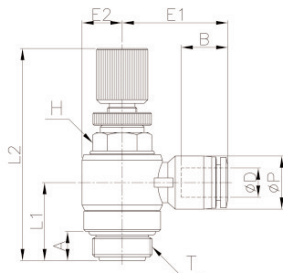

MODELO	T	P	H	C	N	E	B	A	K1	K2	L1	L2	M
NSCP 04-01	4	10.5	R 1/8	15.1	52.4	57.6	23.3	7.0	8.2	15.3	11	29.1	25
NSCP 04-02	4	10.5	R 1/4	18.4	51.3	57.1	25.3	9.0	11.0	15.3	15	40.2	25
NSCP 06-01	6	12.5	R 1/8	15.1	52.4	57.6	24.2	7.0	8.2	16.4	11	29.8	25
NSCP 06-02	6	12.5	R 1/4	18.4	51.3	57.1	26.2	9.0	11.0	16.4	15	41.1	25
NSCP 06-03	6	12.5	R 3/8	21.9	57.0	64.4	27.7	11.0	12.2	16.4	19	65.7	25
NSCP 06-04	6	12.5	R 1/2	26.5	63.4	70.6	30.8	14.0	16.5	16.4	24	103.0	15
NSCP 08-01	8	14.5	R 1/8	16.2	52.4	57.6	25.9	7.0	8.2	18.3	11	30.8	25
NSCP 08-02	8	14.5	R 1/4	19.2	51.3	57.1	27.9	9.0	11.0	18.3	15	42.1	25
NSCP 08-03	8	14.5	R 3/8	21.9	57.0	64.4	28.9	11.0	12.2	18.3	19	66.6	25
NSCP 08-04	8	14.5	R 1/2	26.5	63.4	70.6	31.8	14.0	16.5	18.3	24	103.8	15
NSCP 10-01	10	17.5	R 1/8	17.7	52.4	57.6	27.9	7.0	8.2	19.7	11	32.6	25
NSCP 10-02	10	17.5	R 1/4	20.7	51.3	57.1	29.9	9.0	11.0	19.7	15	43.9	25
NSCP 10-03	10	17.5	R 3/8	23.2	57.0	64.4	31.0	11.2	12.2	19.7	19	68.3	25
NSCP 10-04	10	17.5	R 1/2	26.5	63.4	70.6	33.4	14.0	16.5	19.7	24	105.5	15
NSCP 12-02	12	20.5	R 1/4	22.2	51.3	57.1	33.3	9.0	11.0	22.4	15	46.9	25
NSCP 12-03	12	20.5	R 3/8	24.0	57.0	64.4	33.7	11.5	12.2	21.9	19	71.1	25
NSCP 12-04	12	20.5	R 1/2	28.0	63.4	70.6	36.1	14.0	16.5	21.9	24	107.9	15

**ESC: Regulador con Escape Rápido incorporado y Silenciador Instantáneo Regulación de Rosca > Tubo**

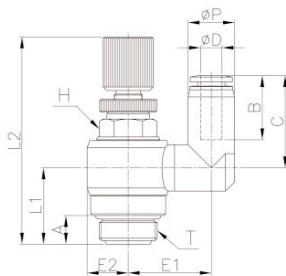

MODELO	T	P	H	C	N	E	B	A	K1	K2	L1	L2
NSSP 04-G01	4	10.5	G 1/8	15.1	52.4	57.6	14.3	7.0	6.0	14.8	11	20.3
NSSP 04-G02	4	10.5	G 1/4	17.6	51.3	57.1	17.8	9.2	8.0	14.8	12	20.2
NSSP 06-G01	6	12.5	G 1/8	15.6	52.4	57.6	15.0	7.0	6.0	16.4	11	24.0
NSSP 06-G02	6	12.5	G 1/4	18.4	51.3	57.1	20.3	9.2	8.0	16.4	12	25.9
NSSP 06-G03	6	12.5	G 3/8	21.9	57.0	64.4	23.3	11.5	8.0	16.4	14	25.9
NSSP 08-G01	8	14.8	G 1/8	15.6	52.4	57.6	16.2	7.0	6.0	18.3	11	24.9
NSSP 08-G02	8	14.8	G 1/4	17.6	51.3	57.1	19.3	9.2	8.0	18.3	12	28.3
NSSP 08-G03	8	14.8	G 3/8	21.9	57.0	64.4	24.6	11.5	8.0	18.3	14	29.3
NSSP 08-G04	8	14.8	G 1/2	23.0	63.4	70.6	26.6	14.3	9.0	18.3	17	29.3
NSSP 10-G02	10	17.5	G 1/4	17.6	51.3	57.1	20.3	9.2	8.0	20.2	12	30.7
NSSP 10-G03	10	17.5	G 3/8	21.9	57.0	64.4	24.6	11.5	8.0	20.2	14	31.7
NSSP 10-G04	10	17.5	G 1/2	23.2	63.4	70.6	26.7	14.3	9.0	20.2	17	33.1
NSSP 12-G02	12	20.5	G 1/4	17.6	51.3	57.1	21.8	9.2	8.0	22.9	12	33.4
NSSP 12-G03	12	20.5	G 3/8	21.9	57.0	64.4	24.6	11.5	8.0	22.9	14	34.4
NSSP 12-G04	12	20.5	G 1/2	23.2	63.4	70.6	26.7	14.3	9.0	22.9	17	35.8