

VÁLVULAS 3 VIAS CON DESCARGA CDC:

Válvulas de cierre. Al posicionar la válvula en "Off" el resto de línea queda descargada de presión. También es válvula unidireccional puesto que el aire circula en un sólo sentido (dibujado en la válvula). Presión de servicio 10 bar. Vacío 750 mmHg. Tubo de 6 a 12mm. Tubo de poliuretano 98 shore y PA12. Sólo para aire comprimido.

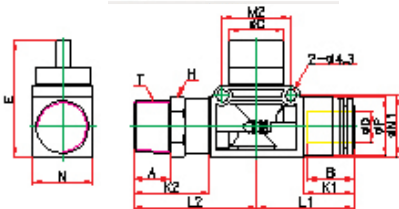

HVC : Válvula 3 Vías Cónica Tubo > Rosca



MODELO	D	T	P	H	C	N	E	B	A	K1	K2	L1	L2	M1	M2	PESO
HVC06-01	6	R 1/8	12.5	14	16.5	18.0	40.5	17.6	8.0	12.2	21.6	26.2	35.6	18.3	19.0	34.7
HVC06-02	6	R 1/4	12.5	14	16.5	18.0	40.5	17.6	10.0	12.2	24.6	26.2	38.6	18.3	19.0	38.7
HVC06-03	6	R 3/8	12.5	17	16.5	18.0	40.5	17.6	11.0	12.2	25.6	26.2	39.6	18.3	19.0	46.7
HVC08-01	8	R 1/8	14.8	14	16.5	18.0	40.5	18.7	8.0	13.0	21.6	27.5	35.6	18.3	19.0	34.7
HVC08-02	8	R 1/4	14.8	14	16.5	18.0	40.5	18.7	10.0	13.0	24.6	27.5	38.6	18.3	19.0	38.7
HVC08-03	8	R 3/8	14.8	17	16.5	18.0	40.5	18.7	11.0	13.0	25.6	27.5	39.6	18.3	19.0	46.7
HVC10-02	10	R 1/4	17.5	17	19.3	21.2	41.0	19.6	10.0	14.5	23.0	31.0	39.5	21.5	24.0	57.2
HVC10-03	10	R 3/8	17.5	17	19.3	21.2	41.0	19.6	11.0	14.5	24.0	31.0	40.5	21.5	24.0	61.2
HVC10-04	10	R 1/2	17.5	21	19.3	21.2	41.0	19.6	14.0	14.5	27.0	31.0	43.5	21.5	24.0	80.2
HVC12-02	12	R 1/4	20.5	19	19.3	21.2	41.0	21.9	10.0	17.7	24.6	34.2	41.1	21.5	24.0	69.1
HVC12-03	12	R 3/8	20.5	19	19.3	21.2	41.0	21.9	11.0	17.7	25.6	34.2	42.1	21.5	24.0	67.1
HVC12-04	12	R 1/2	20.5	21	19.3	21.2	41.0	21.9	14.0	17.7	28.6	34.2	45.1	21.5	24.0	79.1



HVC-G : Válvula 3 Vías Cilíndrica Tubo > Rosca

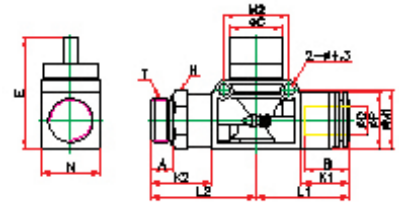

MODELO	D	T	P	H	C	N	E	B	A	K1	K2	L1	L2	M1	M2	PESO
HVC06G01	6	R 1/8	12.5	14	16.5	18.0	40.5	17.6	5.0	12.2	21.6	26.2	35.6	18.3	19.0	34.7
HVC06G02	6	R 1/4	12.5	14	16.5	18.0	40.5	17.6	6.5	12.2	24.6	26.2	38.6	18.3	19.0	38.7
HVC06G03	6	R 3/8	12.5	17	16.5	18.0	40.5	17.6	6.5	12.2	25.6	26.2	39.6	18.3	19.0	46.7
HVC08G01	8	R 1/8	14.8	14	16.5	18.0	40.5	18.7	5.0	13.0	21.6	27.5	35.6	18.3	19.0	34.7
HVC08G02	8	R 1/4	14.8	14	16.5	18.0	40.5	18.7	6.5	13.0	24.6	27.5	38.6	18.3	19.0	38.7
HVC08G03	8	R 3/8	14.8	17	16.5	18.0	40.5	18.7	6.5	13.0	25.6	27.5	39.6	18.3	19.0	46.7
HVC10G02	10	R 1/4	17.5	17	19.3	21.2	41.0	19.6	6.5	14.5	23.0	31.0	39.5	21.5	24.0	57.2
HVC10G03	10	R 3/8	17.5	17	19.3	21.2	41.0	19.6	6.5	14.5	24.0	31.0	40.5	21.5	24.0	61.2
HVC10G04	10	R 1/2	17.5	21	19.3	21.2	41.0	19.6	8.0	14.5	27.0	31.0	43.5	21.5	24.0	80.2
HVC12G02	12	R 1/4	20.5	19	19.3	21.2	41.0	21.9	6.5	17.7	24.6	34.2	41.1	21.5	24.0	69.1
HVC12G03	12	R 3/8	20.5	19	19.3	21.2	41.0	21.9	6.5	17.7	25.6	34.2	42.1	21.5	24.0	67.1
HVC12G04	12	R 1/2	20.5	21	19.3	21.2	41.0	21.9	8.0	17.7	28.6	34.2	45.1	21.5	24.0	79.1



HVF : Válvula 3 Vías Cónica Rosca > Tubo

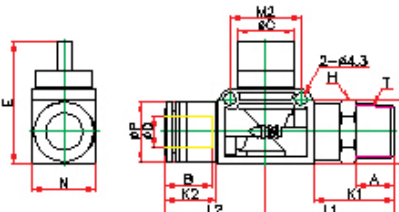

MODELO	T	D	H	P	C	N	E	A	B	K1	K2	L1	L2	M1	M2	PESO
HVF01-06	R 1/8	6	14	12.5	16.5	18.0	40.5	8.0	17.6	21.6	12.2	35.6	26.2	18.3	19.0	34.7
HVF02-06	R 1/4	6	14	12.5	16.5	18.0	40.5	10.0	17.6	24.6	12.2	38.6	26.2	18.3	19.0	38.7
HVF03-06	R 3/8	6	17	12.5	16.5	18.0	40.5	11.0	17.6	25.6	12.2	39.6	26.2	18.3	19.0	46.7
HVF01-08	R 1/8	8	14	14.8	16.5	18.0	40.5	8.0	18.7	21.6	13.0	35.6	27.5	18.3	19.0	34.7
HVF02-08	R 1/4	8	14	14.8	16.5	18.0	40.5	10.0	18.7	24.6	13.0	38.6	27.5	18.3	19.0	38.7
HVF03-08	R 3/8	8	17	14.8	16.5	18.0	40.5	11.0	18.7	25.6	13.0	39.6	27.5	18.3	19.0	46.7
HVF02-10	R 1/4	10	17	17.5	19.3	21.2	41.0	10.0	19.6	23.0	14.5	39.5	31.0	21.5	24.0	57.2
HVF03-10	R 3/8	10	17	17.5	19.3	21.2	41.0	11.0	19.6	24.0	14.5	40.5	31.0	21.5	24.0	61.2
HVF04-10	R 1/2	10	21	17.5	19.3	21.2	41.0	14.0	19.6	27.0	14.5	43.5	31.0	21.5	24.0	80.2
HVF02-12	R 1/4	12	19	20.5	19.3	21.2	41.0	10.0	21.9	24.6	17.7	41.1	34.2	21.5	24.0	69.1
HVF03-12	R 3/8	12	19	20.5	19.3	21.2	41.0	11.0	21.9	25.6	17.7	42.1	34.2	21.5	24.0	67.1
HVF04-12	R 1/2	12	21	20.5	19.3	21.2	41.0	14.0	21.9	28.6	17.7	45.1	34.2	21.5	24.0	79.1



HVF-G : Válvula 3 Vías Cilíndrica Rosca > Tubo

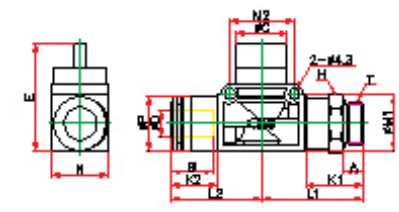

MODELO	T	D	H	P	C	N	E	A	B	K1	K2	L1	L2	M1	M2	PESO
HVF01-G06	1/8	6	14	12.5	16.5	18.0	40.5	5.0	17.6	21.6	12.2	35.6	26.2	18.3	19.0	34.7
HVF02-G06	1/4	6	14	12.5	16.5	18.0	40.5	6.5	17.6	24.6	12.2	38.6	26.2	18.3	19.0	38.7
HVF03-G06	3/8	6	17	12.5	16.5	18.0	40.5	6.5	17.6	25.6	12.2	39.6	26.2	18.3	19.0	46.7
HVF01-G08	1/8	8	14	14.8	16.5	18.0	40.5	5.0	18.7	21.6	13.0	35.6	27.5	18.3	19.0	34.7
HVF02-G08	1/4	8	14	14.8	16.5	18.0	40.5	6.5	18.7	24.6	13.0	38.6	27.5	18.3	19.0	38.7
HVF03-G08	3/8	8	17	14.8	16.5	18.0	40.5	6.5	18.7	25.6	13.0	39.6	27.5	18.3	19.0	46.7
HVF02-G10	1/4	10	17	17.5	19.3	21.2	41.0	6.5	19.6	23.0	14.5	39.5	31.0	21.5	24.0	57.2
HVF03-G10	3/8	10	17	17.5	19.3	21.2	41.0	6.5	19.6	24.0	14.5	40.5	31.0	21.5	24.0	61.2
HVF04-G10	1/2	10	21	17.5	19.3	21.2	41.0	8.0	19.6	27.0	14.5	43.5	31.0	21.5	24.0	80.2
HVF02-G12	1/4	12	19	20.5	19.3	21.2	41.0	6.5	21.9	24.6	17.7	41.1	34.2	21.5	24.0	69.1
HVF03-G12	3/8	12	19	20.5	19.3	21.2	41.0	6.5	21.9	25.6	17.7	42.1	34.2	21.5	24.0	67.1
HVF04-G12	1/2	12	21	20.5	19.3	21.2	41.0	8.0	21.9	28.6	17.7	45.1	34.2	21.5	24.0	79.1