

FLUIDFIT RACORES TUBO EN PULGADAS (INCH) ROSCA NPT EN COLOR MARFIL

RACORES PARA TUBERIAS EN PULGADAS (EXT) Y ROSCAS TIPO NPT.

Fluid type	Water, Beverages	
Tube type	Polyethylene(PE), Polyamide(PA) and Polyurethane(PU)	
Temperature	Working Pressure	
	4mm~8mm	10mm~12mm
1°C	16Bar	10Bar
25°C	16Bar	10Bar
70°C	10Bar	7Bar

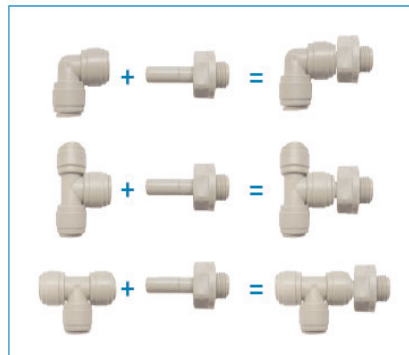

Maximum Torque Values for BSP, BSPT and NPT Plastic Threads

Threads	1/8	1/4	3/8	1/2
Max. Torque	1.5Nm	1.5Nm	3.0Nm	3.0Nm



HPC Recto T - R

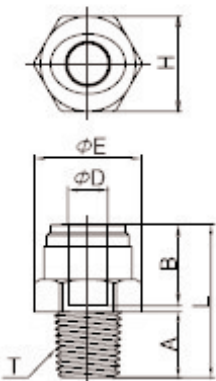

MODEL	ØD	T (NPTF)	A	B TUBE DEEP	ØE	H (INCH)	L	WEIGHT (g)	BOX (EA)
HPC 5/32-N01	5/32	1/8	9.1	14.7	17.8	15.8(5/8)	22.2	3.2	100
HPC 5/32-N02	5/32	1/4	13.2	14.7	17.8	15.8(5/8)	25.3	4.3	100
HPC 3/16-N01	3/16	1/8	9.1	15.0	17.8	15.8(5/8)	22.4	3.1	100
HPC 3/16-N02	3/16	1/4	13.2	15.0	17.8	15.8(5/8)	25.5	4.2	100
HPC 1/4-N01	1/4	1/8	9.1	16.9	17.8	15.8(5/8)	27.0	3.9	100
HPC 1/4-N02	1/4	1/4	13.2	16.9	17.8	15.8(5/8)	27.0	4.3	100
HPC 1/4-N03	1/4	3/8	13.8	16.9	21.4	19.0(3/4)	28.1	6.1	50
HPC 5/16-N01	5/16	1/8	9.1	17.5	21.4	19.0(3/4)	28.4	5.8	100
HPC 5/16-N02	5/16	1/4	13.2	17.5	21.4	19.0(3/4)	27.9	5.2	50
HPC 5/16-N03	5/16	3/8	13.8	17.5	21.4	19.0(3/4)	26.5	6.0	50
HPC 5/16-N04	5/16	1/2	17.8	17.5	25	22.2(7/8)	33.5	11.5	50
HPC 3/8-N01	3/8	1/8	9.1	20.2	23	20.8(13/16)	30.4	6.7	50
HPC 3/8-N02	3/8	1/4	13.2	20.2	23	20.8(13/16)	34.3	7.9	50
HPC 3/8-N03	3/8	3/8	13.8	20.2	23	20.8(13/16)	29.9	7.5	50
HPC 3/8-N04	3/8	1/2	17.8	20.2	25	22.2(7/8)	33.9	11.0	50
HPC 1/2-N03	1/2	3/8	13.8	25.1	27.4	24.5(31/32)	38.4	11.7	50
HPC 1/2-N04	1/2	1/2	17.8	25.1	27.4	24.5(31/32)	37.9	12.7	50

HCF Hembra R-T

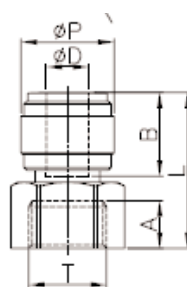

MODEL	ØD	ØP	T (NPTF)	L	A	B TUBE DEEP	H(HEX)	ØE	WEIGHT (g)
HCF 1/4-N01	1/4	15.5	1/8	30.9	11.5	16.9	17	19	6.1
HCF 1/4-N02	1/4	15.5	1/4	30.9	11.5	16.9	19	21.5	6.5
HCF 3/8-N02	3/8	20	1/4	34.2	11.5	20.2	19	21.5	8.5

HCJ Espiga T-R



MODEL	ØD	T (NPTF)	A	B	ØE	H(HEX)	L	WEIGHT (g)	BOX (EA)
HCJ 5/32-N01	5/32	1/8	9.1	18.0	14.1	12.7(1/2)	33.1	1.9	100
HCJ 5/32-N02	5/32	1/4	13.2	18.0	17.8	15.8(5/8)	37.2	3.6	100
HCJ 3/16-N01	3/16	1/8	9.1	18.0	14.1	12.7(1/2)	33.1	2.0	100
HCJ 1/4-N01	1/4	1/8	9.1	19.0	14.1	12.7(1/2)	34.1	2.1	100
HCJ 1/4-N02	1/4	1/4	13.2	19.0	17.8	15.8(5/8)	38.2	3.8	100
HCJ 5/16-N01	5/16	1/8	9.1	20.0	14.1	12.7(1/2)	35.1	2.8	100
HCJ 5/16-N02	5/16	1/4	13.2	20.0	17.8	15.8(5/8)	39.2	3.9	50
HCJ 5/16-N03	5/16	3/8	13.8	20.0	21.5	19.0(3/4)	40.3	5.9	50
HCJ 3/8-N02	3/8	1/4	13.2	23.0	17.8	15.8(5/8)	42.2	4.5	50
HCJ 3/8-N03	3/8	3/8	13.8	23.0	21.5	19.0(3/4)	43.3	6.5	50
HCJ 1/2-N03	1/2	3/8	13.8	27.0	21.5	19.0(3/4)	47.3	6.9	50
HCJ 1/2-N04	1/2	1/2	17.8	27.0	26.8	23.8(15/16)	51.3	11.4	25

