

HUY Racor Y

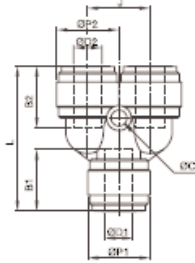

MODEL	ØD1	ØD2	B1 TUBE DEEP	B2 TUBE DEEP	ØP1	ØP2	L	J	ØC	WEIGHT (g)	BOX (EA)
HUY 5/32-5/32	5/32	5/32	14.7	14.7	13.8	13.8	33.7	13.5	3.3	6.7	100
HUY 3/16-3/16	3/16	3/16	15.0	15.0	13.8	13.8	34.1	13.5	3.3	6.8	50
HUY 1/4-1/4	1/4	1/4	16.9	16.9	15.5	15.5	38.8	15.5	3.3	8.8	50
HUY 5/16-5/16	5/16	5/16	17.5	17.5	17.6	17.6	41.0	17.6	4.5	11.8	50
HUY 3/8-3/8	3/8	3/8	20.2	20.2	20	20	46.4	20.0	4.5	16.7	25
HUY 1/2-1/2	1/2	1/2	25.1	25.1	23	23	56.8	23.0	4.5	25.1	20

HLJ Codo Espiga-T

StemElbow

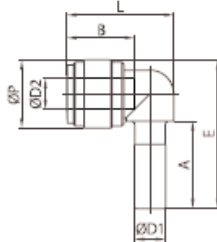

MODEL	ØD1	ØD2	ØP	A	B2 TUBE DEEP	E	L	WEIGHT (g)	BOX (EA)
HLJ 5/32-5/32	5/32	5/32	13.2	18.0	14.7	30.1	21.9	2.5	100
HLJ 3/16-3/16	3/16	3/16	13.8	18.5	15.0	31.4	22.5	2.9	100
HLJ 1/4-1/4	1/4	1/4	15.5	21.0	16.9	34.8	25.1	3.7	100
HLJ 5/16-5/16	5/16	5/16	17.6	22.5	17.5	38.3	27.7	5.4	50
HLJ 3/8-1/4	3/8	1/4	15.5	24.8	16.9	38.6	25.1	4.5	50
HLJ 3/8-5/16	3/8	5/16	20.0	24.8	17.5	43.2	31.0	8.1	50
HLJ 3/8-3/8	3/8	3/8	20.0	24.8	20.2	43.2	31.4	7.9	50
HLJ 1/2-1/2	1/2	1/2	23.6	29.5	25.1	51.2	39.2	12.7	25

HGJ Espiga - Tubo

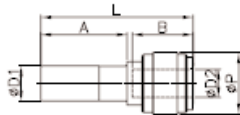

MODEL	ØD1	ØD2	ØP	L	A	B	WEIGHT (g)	BOX (EA)
HGJ 1/4-5/32	1/4	5/32	13.2	36.7	21	14.7	2.4	100
HGJ 5/16-1/4	5/16	1/4	15.5	40.6	22.5	16.9	3.4	100
HGJ 3/8-1/4	3/8	1/4	17.6	43.9	24.8	16.9	4.7	50
HGJ 3/8-5/16	3/8	5/16	17.6	44.3	24.8	17.5	4.6	50
HGJ 1/2-3/8	1/2	3/8	20	51.7	29.5	20.2	7.1	50

HMM Pasamuros

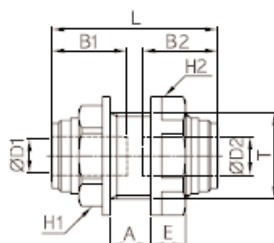

MODEL	ØD1	ØD2	T	L	E	A	B1 TUBE DEEP	B2 TUBE DEEP	H1 (Hex)	H2 (Hex)	WEIGHT (g)	BOX (EA)
HMM 5/32-5/32	5/32	5/32	M15×1.5p	32.4	6.5	8.1	14.7	14.7	17	18	6.9	50
HMM 1/4-1/4	1/4	1/4	M17×1.5p	35.7	7.0	9.4	16.9	16.9	19	21	9.4	50
HMM 1/4-3/8	1/4	3/8	M24×1.75p	47.9	8.5	11.1	16.9	20.2	24	28.5	20.9	25
HMM 5/16-5/16	5/16	5/16	M20×1.75p	38.5	8.0	9.4	17.5	17.5	21	25.5	14.2	25
HMM 3/8-3/8	3/8	3/8	M24×1.75p	42.4	8.5	11.1	20.2	20.2	24	28.5	20.1	25
HMM 1/2-1/2	1/2	1/2	M27×2.0p	51.8	9.0	16.4	25.1	25.1	27	31	27.6	20